

FIRE REQUIREMENTS:

FIRE DETECTORS:
BE SABS APPROVED UNITS - SERVICED ONCE PER ANNUM BY A REGISTERED HOLDER OF A CERTIFICATE OF COMPETENCE. INSTALL, MAINTAINED AND SERVICED IN ACCORDANCE WITH THE RELEVANT SABS CODES OF PRACTICE.

HOSE REELS:
20 LOCATED THAT THE END OF THE HOSE CAN REACH ANY POINT WITHIN THE PROTECTED AREA. DISCHARGE WATER AT A MINIMUM FLOW RATE OF 625 l/min AT A MINIMUM PRESSURE OF 300 kPa. BE 30 m SABS S43 APPROVED.

HYDRANTS:
DISCHARGE WATER AT A MINIMUM FLOW RATE OF 250 l/min AT A MINIMUM PRESSURE OF 300 kPa AND A MAXIMUM OF 700 kPa.

FIRE WATER SUPPLY:
THE SUPPLY OF WATER FOR A FIRE / COMBINED INSTALLATION MUST BE IN ACCORDANCE WITH THE PROVISIONS OF SANS 10223-1.

SUPPRESSION EQUIPMENT:
SHALL BE CLEARLY VISIBLE AND WHERE NOT, BE INDICATED BY MEANS OF SABS APPROVED SAFETY SYMBOLIC SIGNS.

ESCAPE DOORS:
SHALL LEAD TO OPEN FLOOR DIRECTLY TO A STREET OR APPROVED OPEN SPACE. BE FITTED WITH A PANIC BOLT OR SIMILAR APPROVED OPENING DEVICE. BE REINFORCED DIRECTLY ABOVE DOOR WITH SABS APPROVED SOUNGE AS BEING AN EMERGENCY ESCAPE DOOR. SHALL NOT BE LOADED OR HINDERED LESS OPENABLE IN ANY WINTER WHATSOEVER DURING HOURS OF BUSINESS.

SOUNGE - EMERGENCY/ESCAPE ROUTES:
SABS APPROVED PHOTO-LUMINESCENT SAFETY SYMBOLIC SIGNS (SHOWING WAY AND DIRECTION, ARROW) TO BE ADEQUATELY PROVIDED TO CLEARLY INDICATE DIRECTION OF TRAVEL FOR ESCAPE PURPOSES. ESCAPE ROUTE PATH TO BE KEPT CLEAR AND UNOBSTRUCTED AT ALL TIMES.

EMERGENCY LIGHTING:
SHALL BE INDEPENDENT OF THE NORMAL MAINS SUPPLY AND FUNCTION FOR A MINIMUM PERIOD OF 60 OR 120 MINUTES, WHICHEVER IS REQUIRED, IN THE EVENT OF NORMAL MAINS FAILURE.

FIRE RATED OR SMOKE STOP DOORS:
SHALL BE FITTED WITH AN AUTOMATIC SELF-CLOSING DEVICE. SHALL REMAIN IN THE CLOSED POSITION ON THE KEYS OPEN BY A FIRE/SMOKE DETECTOR ACTIVATED ELECTROMAGNETIC OR SIMILARLY APPROVED DEVICE.

FIRE STOPPING:
ANY SERVICES PASSING THROUGH (HORIZONTAL OR VERTICAL) A FIRE RATED WALL/CONCRETE/SLAB ELEMENT SHALL BE ADEQUATELY FIRE STOPPED.

SEWERING:
NO SEWERING FROM THE BUILDINGS AS INDICATED ON THE PLAN OR THE STIPULATED REQUIREMENTS, ARE PERMITTED.

HEALTH REQUIREMENTS:

ALL WORKING SURFACES IN THE KITCHENS MUST BE OF SANITARY, HARD, IMPERVIOUS AND EASILY CLEANABLE MATERIAL, FREE OF OPEN JOINTS, CRACKS OR SEAMS.

A CONSTANT SUPPLY OF HOT WATER MUST BE Laid ON TO ALL WASH-UP FACILITIES.

ANY PROPOSED MECHANICAL VENTILATION SYSTEM MUST BE DESIGNED BY OR UNDER THE SUPERVISION OF A PROFESSIONAL ENGINEER OR OTHER APPROVED REGISTERED PERSON AND SUCH REGISTERED PERSON MUST PROVIDE A CERTIFIED STATEMENT TO THE EFFECT THAT THE SYSTEM HAS BEEN DESIGNED IN ACCORDANCE WITH THE PROVISIONS OF THE NATIONAL BUILDING STANDARDS ACT 103 OF 1977. DETAILS OF THE MECHANICAL VENTILATION SYSTEM MUST RELATE SPECIFICALLY AS TO THE POSITION OF AIRWAYS, FLOWING AIRLETS, OUTLETS, GRILLES AND LOUVERES AS WELL AS THE PROPOSED RATES OF AIR SUPPLY AND OR EXTRACTING AT ANY SUCH OPENINGS.

ALL WASTE BE EXTRACTED FROM THE WATER CLOSET COULDES AT A RATE OF AT LEAST 30 LITRES/SECOND WASTE AND SOIL FITTINGS. THE WALL AREAS BEHIND ALL SINKS AND THE WASH HAND BASINS MUST BE TILED TO A HEIGHT OF AT LEAST 300 MM.

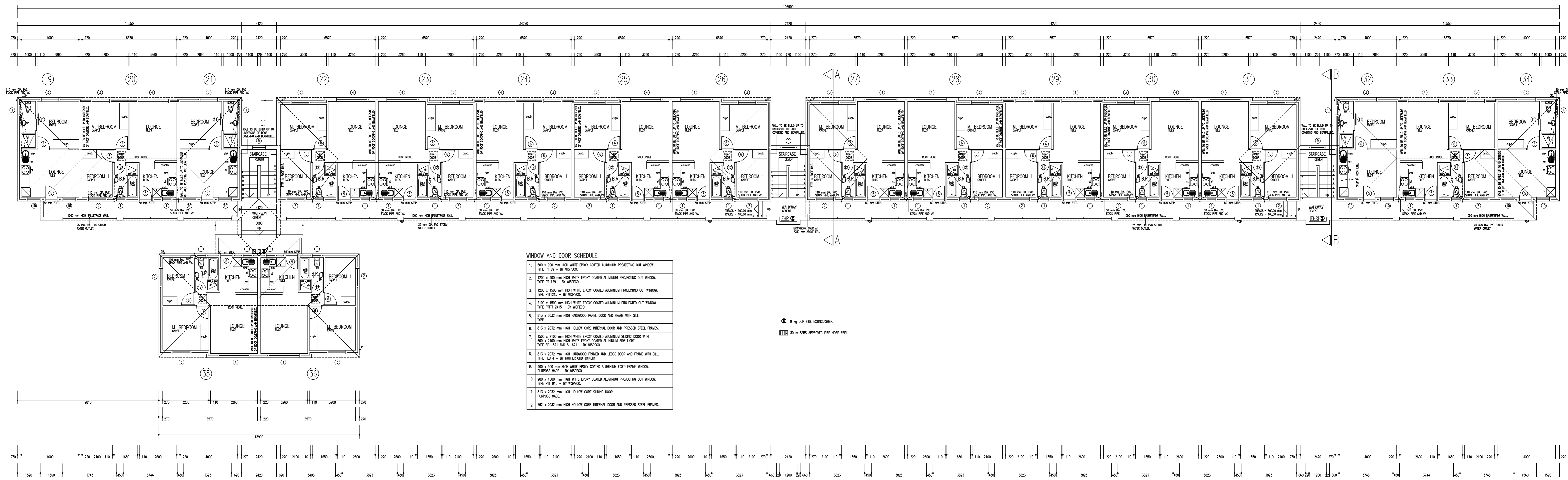
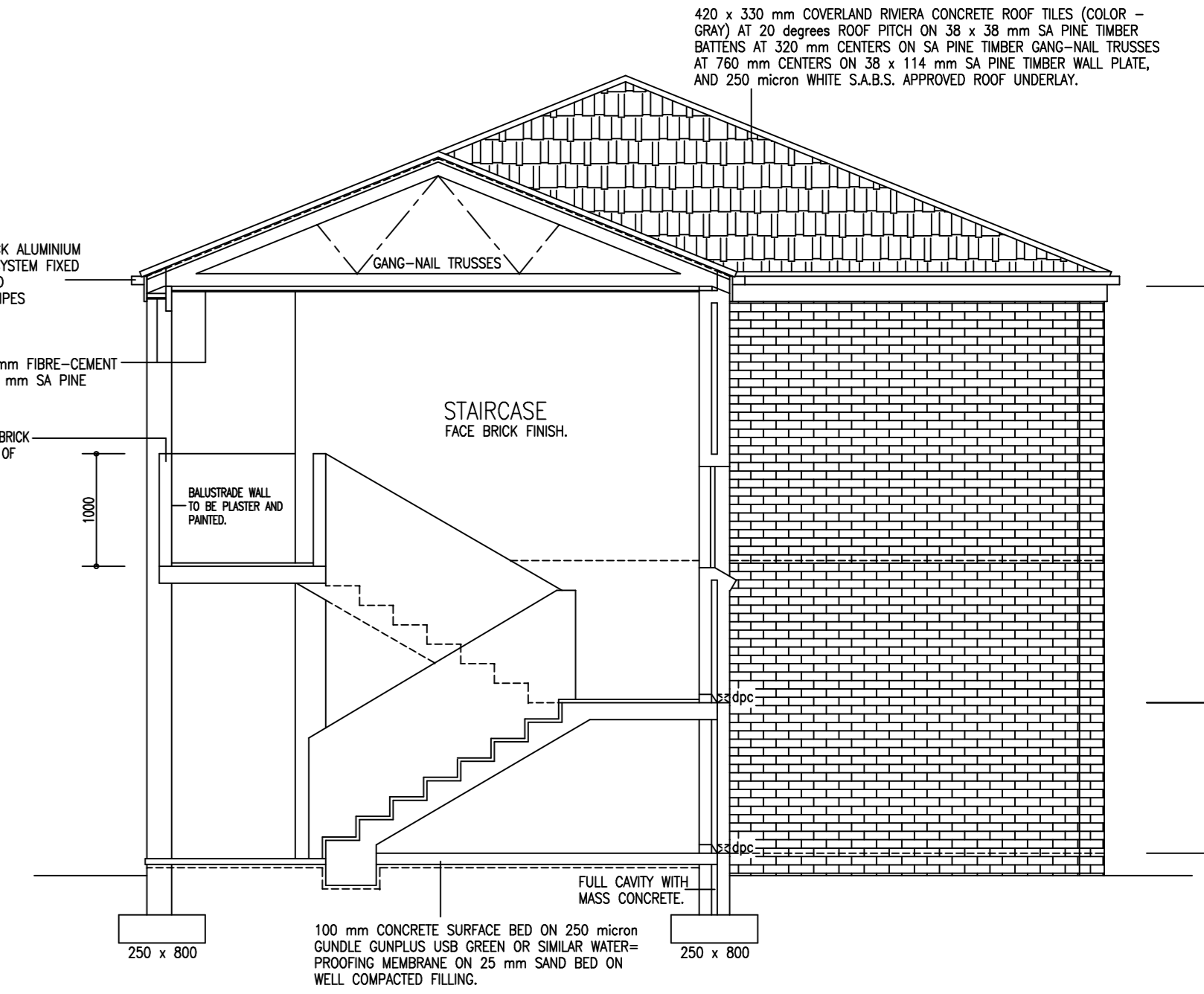
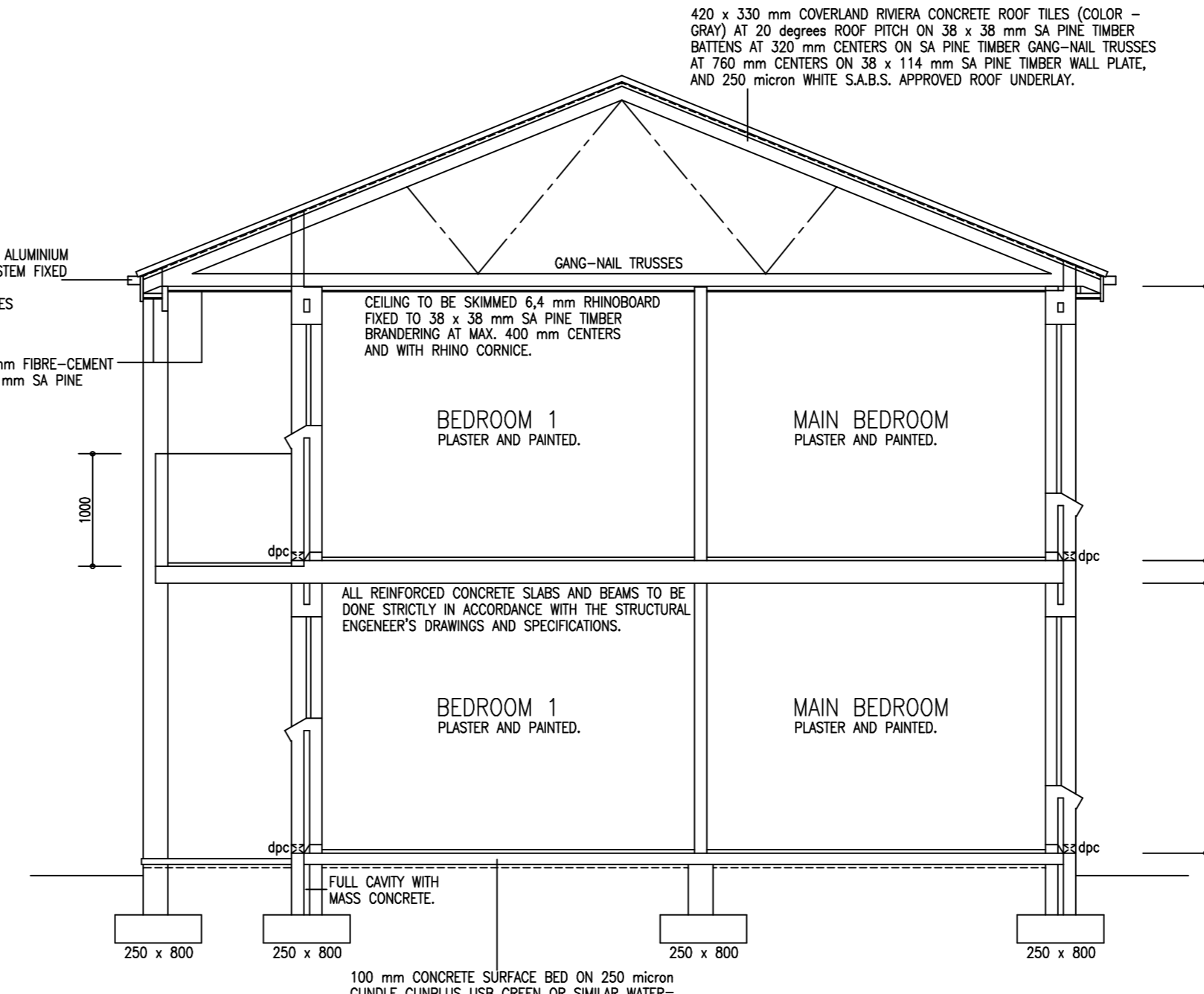

WINDOW AND DOOR SCHEDULE:

1.	200 x 1000 mm HIGH WHITE EPOXY COATED ALUMINUM PROJECTING OUT WINDOW. TYPE PF 68 - BY INSPECO.
2.	1200 x 800 mm HIGH WHITE EPOXY COATED ALUMINUM PROJECTING OUT WINDOW. TYPE PF 129 - BY INSPECO.
3.	1200 x 1500 mm HIGH WHITE EPOXY COATED ALUMINUM PROJECTING OUT WINDOW. TYPE PFI1215 - BY INSPECO.
4.	2100 x 1500 mm HIGH WHITE EPOXY COATED ALUMINUM PROJECTING OUT WINDOW. TYPE PFI1215 - BY INSPECO.
5.	813 x 2032 mm HIGH HARDWOOD PANEL DOOR AND FRAME WITH SILL. TYPE - BY SUTHERFORD JOINERY.
6.	813 x 2032 mm HIGH HOLLOW CORE INTERNAL DOOR AND PRESSED STEEL FRAMES. TYPE - BY SUTHERFORD JOINERY.
7.	1200 x 2100 mm HIGH WHITE EPOXY COATED ALUMINUM SLIDING DOOR WITH 800 x 2100 mm HIGH WHITE EPOXY COATED ALUMINUM SLIDING ALUMINUM SILL LIGHT. TYPE SF 1020 AND SF 1021 - BY INSPECO.
8.	813 x 2032 mm HIGH HARDWOOD FRAMED AND LINED DOOR AND FRAME WITH SILL. TYPE FIB 4 - BY SUTHERFORD JOINERY.
9.	300 x 300 mm HIGH WHITE EPOXY COATED ALUMINUM FIXED WINDOW. CORNERED. TYPE - BY INSPECO.
10.	300 x 1500 mm HIGH WHITE EPOXY COATED ALUMINUM PROJECTING OUT WINDOW. TYPE PF 613 - BY INSPECO.
11.	813 x 2032 mm HIGH HOLLOW CORE SLIDING DOOR. PURPOSE WARE.
12.	742 x 2032 mm HIGH HOLLOW CORE INTERNAL DOOR AND PRESSED STEEL FRAMES.

REVISION - HERSIENING	NOTE
	COPYRIGHT RESERVED ON THIS DRAWING.
	GIVEN DIMENSIONS TO BE TAKEN IN PREFERENCE TO SCALE.
	SCALE: 1:100 DATE: MAR. 09
	DESIGN: dDw DRAWN: dDw
	CHECKED:

SIRROCCO'S PLAZA

PROJECT: NEW BLOCK OF FLATS FOR JORTRADE GLOBAL PTY LTD
STAND: 40035
DRAWING: FIRST FLOOR AND SECTIONS.
MUNICIPALITY: BELLVILLE

danie de wet
- building designs -
SOUTH AFRICAN COUNCIL FOR THE ARCHITECTURAL PROFESSION - 1144
VILLA SONDRIO 6 P.O. BOX 4342 TYGERVALLEY
DURBANVILLE BELLVILLE 7536
TEL. (021) 975 7002 CELL. 082-8686 219

PROJECT NO. 0760
DRAWING NO. 04